

**CAPTIVA ISLAND
PROPERTY OWNERS ASSOCIATION**

CAPTIVA DRIVE SIDEWALK DESIGN

FROM ANDY ROSSE LANE TO POST OFFICE
JEI PROJECT ID: 20192117-000

LEE COUNTY, FLORIDA

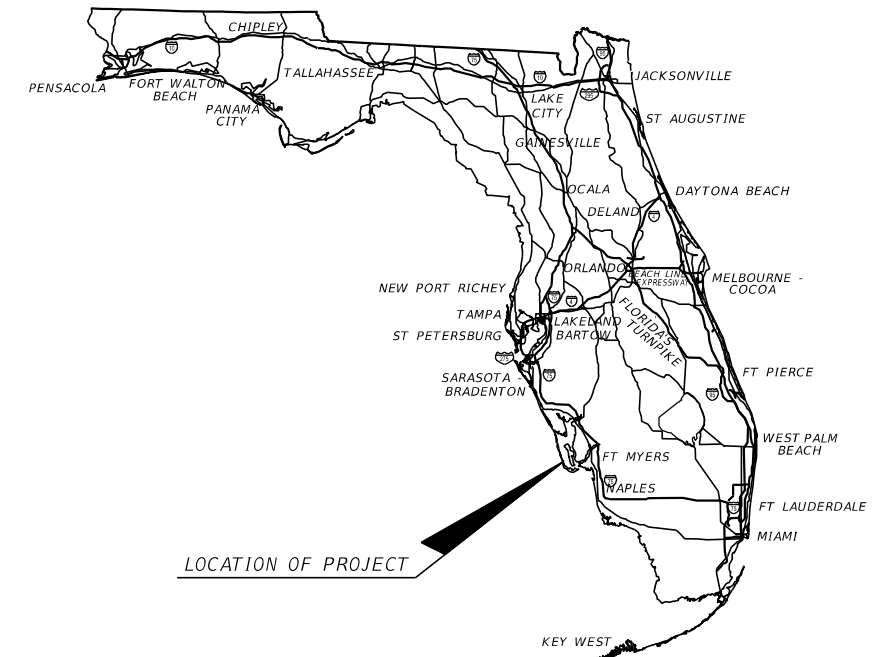

INDEX OF ROADWAY PLANS

SHEET NO.	SHEET DESCRIPTION
1	KEY SHEET
2	SUMMARY OF PAY ITEMS
3-4	TYPICAL SECTIONS
5	SUMMARY OF DRAINAGE
6	PROJECT NOTES
7	PROJECT LAYOUT
8 - 14	PLAN AND PROFILE
XX - XX	DRAINAGE STRUCTURES
15 - 21	CROSS SECTIONS

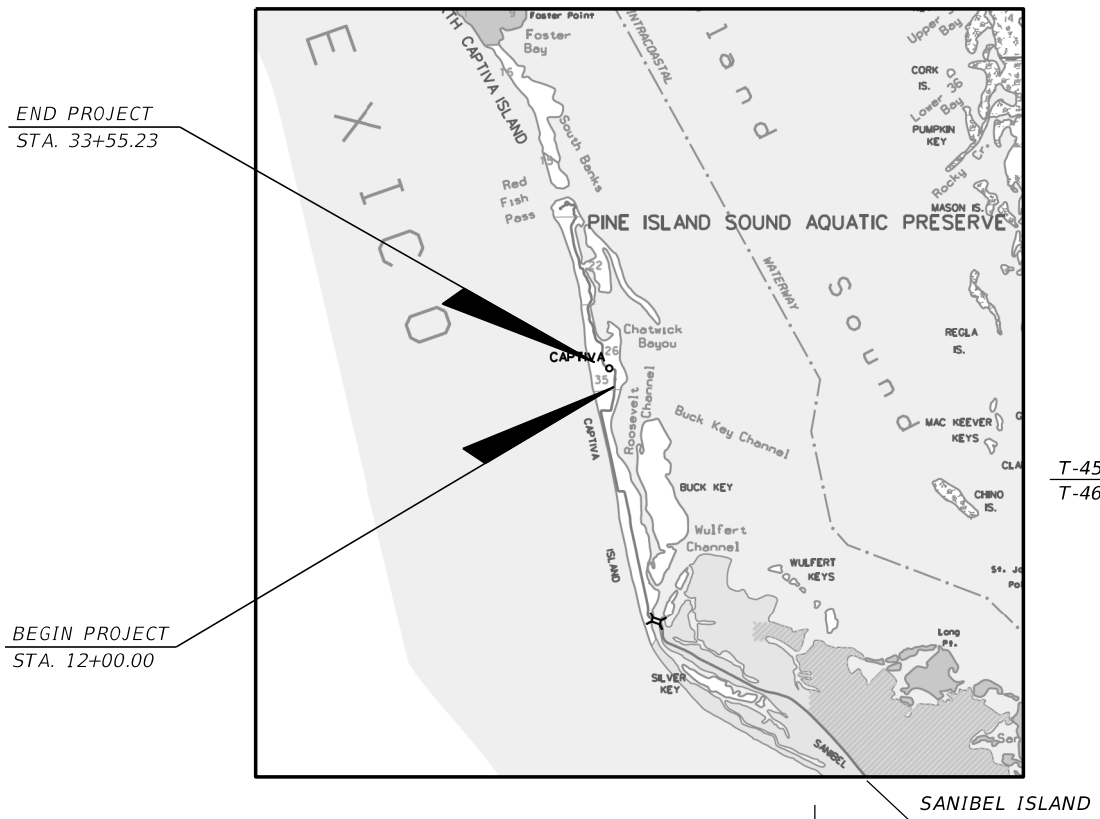

**SIDEWALK SHOP DRAWINGS
TO BE SUBMITTED TO:**

JOHN T. GLENN, P.E.
P.E. LICENSE NUMBER 84227
JOHNSON ENGINEERING, INC.
2212 JOHNSON STREET
FORT MYERS, FLORIDA 33901

PLANS PREPARED BY:



JOHN T. GLENN, P.E.
P.E. LICENSE NUMBER 84227
JOHNSON ENGINEERING, INC.
2212 JOHNSON STREET
FORT MYERS, FLORIDA 33901
CERTIFICATE OF AUTHORIZATION NO. 642

**NOTE: THE SCALE OF THESE PLANS MAY
HAVE CHANGED DUE TO REPRODUCTION.**

**60% SUBMITTAL
SEPTEMBER 2019**

48 HOURS BEFORE DIGGING
"CALL SUNSHINE"
1-800-432-4770



**ROADWAY PLANS
ENGINEER OF RECORD: JOHN T. GLENN**

P.E. NO.: 84227

CONSTRUCTION CONTRACT NO.	FISCAL YEAR	SHEET NO.
	19	1

GOVERNING STANDARD PLANS:

Florida Department of Transportation, FY2018-19 Standard Plans for Road and Bridge Construction and applicable Interim Revisions (IRs).

Standard Plans for Road Construction and associated IRs are available at the following website: <http://www.fdot.gov/design/standardplans>

Standard Plans for Bridge Construction are included in the Structures Plans Component

GOVERNING STANDARD SPECIFICATIONS:

Florida Department of Transportation, January 2019 Standard Specifications for Road and Bridge Construction at the following website: <http://www.fdot.gov/programmanagement/Implemented/SpecBooks>

THE OFFICIAL RECORD OF THIS SHEET IS THE ELECTRONIC FILE DIGITALLY SIGNED AND SEALED UNDER RULE 61G15-23.004, F.A.C.

SUMMARY OF ROADWAY			
PAY ITEM NO.	DESCRIPTION	UNIT	QUANTITY
101-1	MOBILIZATION	LS	
102-1	MAINTENANCE OF TRAFFIC	LS	
104-10-3	SEDIMENT BARRIER	LF	
104-18	INLET PROTECTION	EA	
110-1-1	CLEARING & GRUBBING	LS	
120-1	EXCAVATION	CY	
120-6	EMBANKMENT	CY	
522-2	SIDEWALK/DRIVEWAY CONCRETE, 6" THICK	SY	
570-1-2	PERFORMANCE TURF (SOD)	SY	
570-1-2	PERFORMANCE TURF (SOD) (CONTINGENCY)	SY	
700-1-50	SINGLE POST SIGN, RELOCATE	AS	
700-1-60	SINGLE POST SIGN, REMOVE	AS	

PAY ITEM FOOTNOTES:

- 110-1-1 CLEARING AND GRUBBING SHALL INCLUDE, BUT NOT BE LIMITED TO, THE REMOVAL OF ASPHALT, CONCRETE, ROADWAY BASE, STORM STRUCTURE, PIPES, GUARDRAIL VEGETATION / TREE, ROOTS, TREE TRIMMING CURB & GUTTER, SIDEWALK AND FENCE. ALL CLEARING AND GRUBBING DEBRIS SHALL BE REMOVED FROM JOB SITE BY THE CONTRACTOR AT NO ADDITIONAL COST TO THE CITY.
- 522-2 INCLUDES THE COST OF DETECTABLE WARNING SURFACE. DETECTABLE WARNING SURFACE TO BE CAST IN PLACE NOT SCREWED DOWN.

REVISIONS				 JOHNSON ENGINEERING <small>JOHN T. GLENN • P.E. LICENSE NO. 84227 JOHNSON ENGINEERING, INC. 2122 JOHNSON STREET • FORT MYERS, FL 33901 CERTIFICATE OF AUTHORIZATION NO. 642</small>	CAPTIVA ISLAND PROPERTY OWNERS ASSOCIATION			<p style="text-align: center;"><i>SUMMARY OF PAY ITEMS</i></p>	SHEET NO.
DATE	DESCRIPTION	DATE	DESCRIPTION		ROAD NO.	COUNTY	JEI PROJECT ID		2
						LEE	20192117-000		

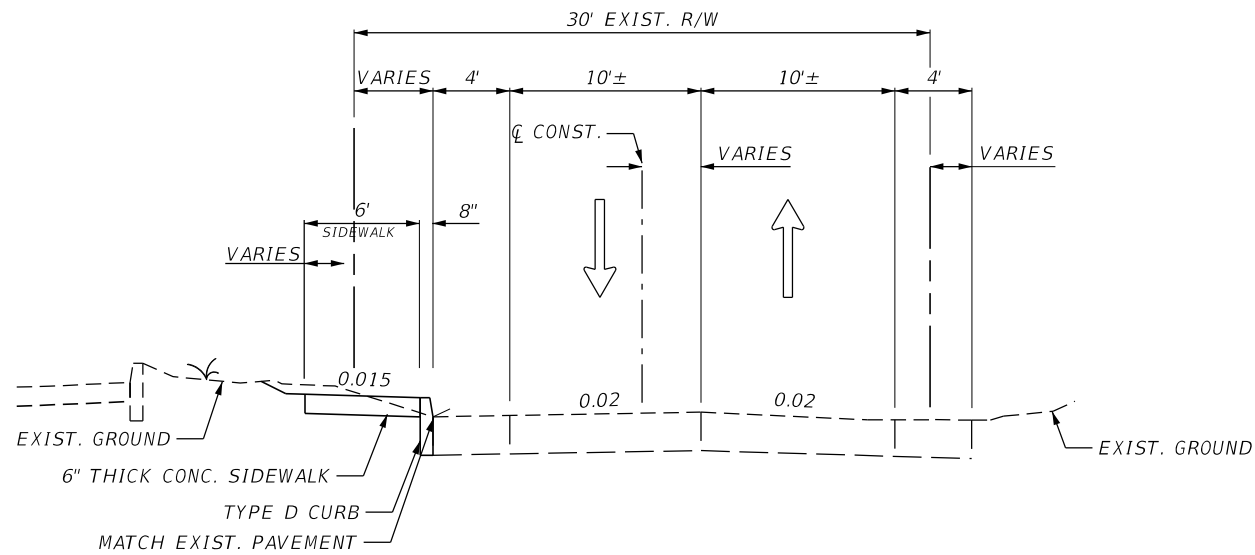

TYPICAL SECTION
STA. 27+20.00 TO STA. 29+50.00

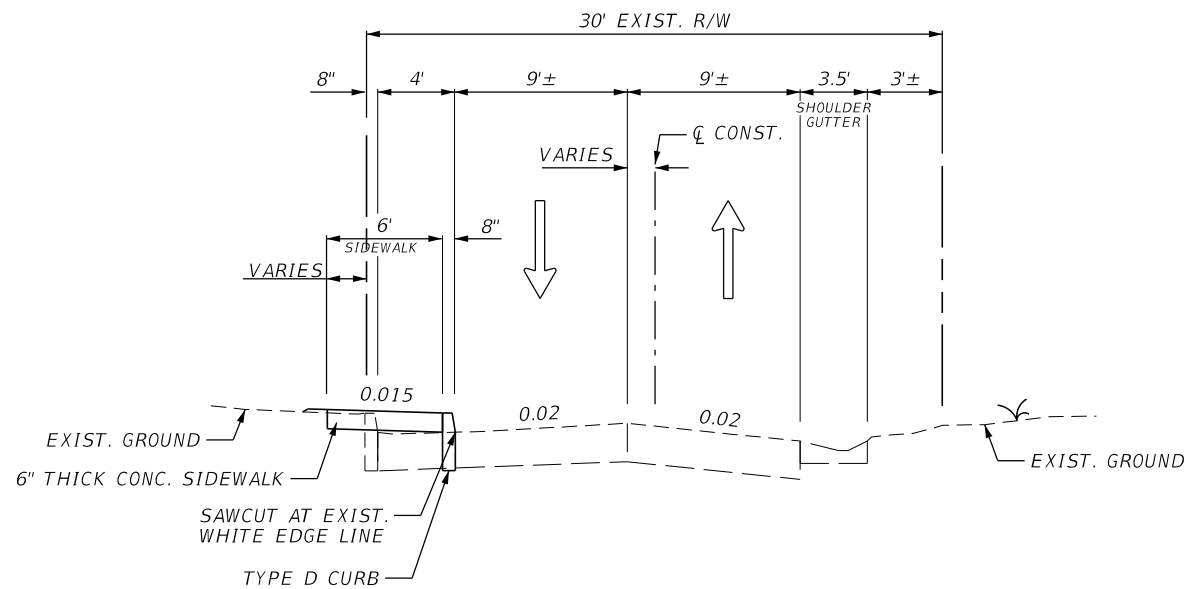

TYPICAL SECTION
STA. 12+00.00 TO STA. 27+20.00
STA. 29+50.00 TO STA. 33+55.23

REVISIONS			
DATE	DESCRIPTION	DATE	DESCRIPTION

JOHNSON ENGINEERING
 JOHN T. GLENN • P.E. LICENSE NO. 84227
 JOHNSON ENGINEERING, INC.
 2122 JOHNSON STREET • FORT MYERS, FL 33901
 CERTIFICATE OF AUTHORIZATION NO. 642

CAPTIVA ISLAND PROPERTY OWNERS ASSOCIATION		
ROAD NO.	COUNTY	JEI PROJECT ID
	LEE	20192117-000

TYPICAL SECTIONS	
3	

SHEET NO.
3

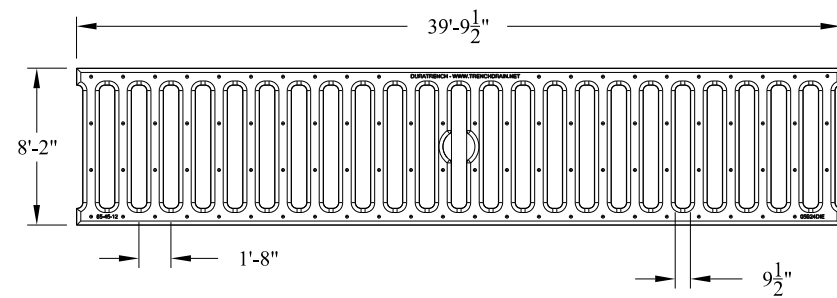

NOTES:

1. GRATE MATERIAL IS CAST DUCTILE IRON 65-45-12
2. GRATES ARE LOAD CLASS E, EXCEEDS H-20 LOADING
3. GRATES ARE HOT DIP GALVANIZED
4. GRATE OPEN AREA 21.14 IN.²/LF

05B24DG SLOTTED DUCTILE IRON GRATE

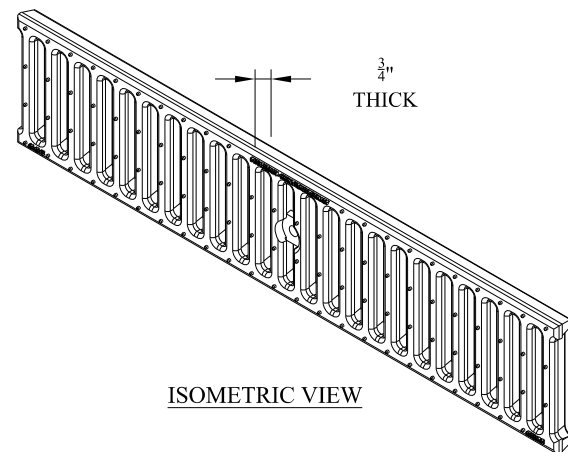

ISOMETRIC VIEW

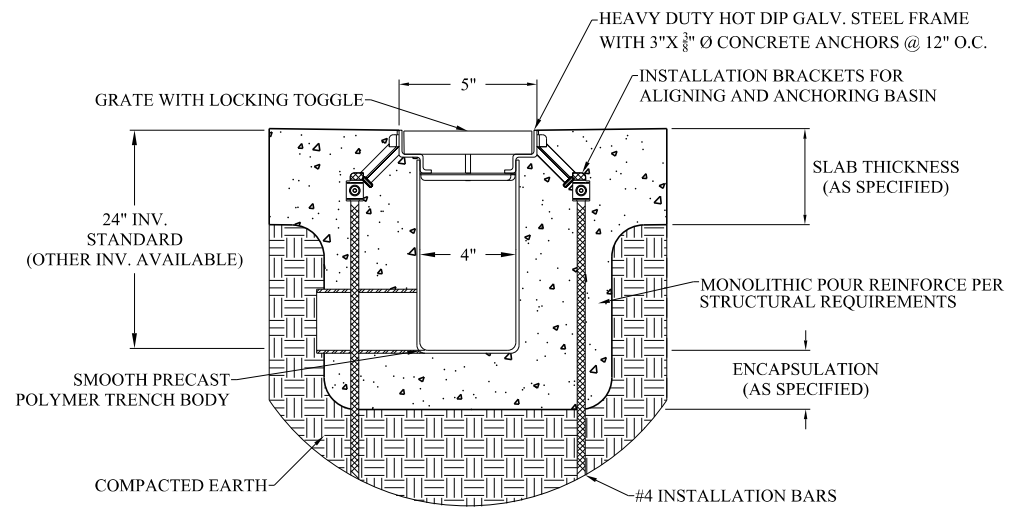

- NOTES:
1. REINFORCE ACCORDING TO STRUCTURAL REQUIREMENTS
 2. CATCH BASIN MUST BE $\frac{1}{8}$ " BELOW FINISHED CONCRETE GRADE

TYPICAL DTCBPF4-HDGS CATCH BASIN SECTION

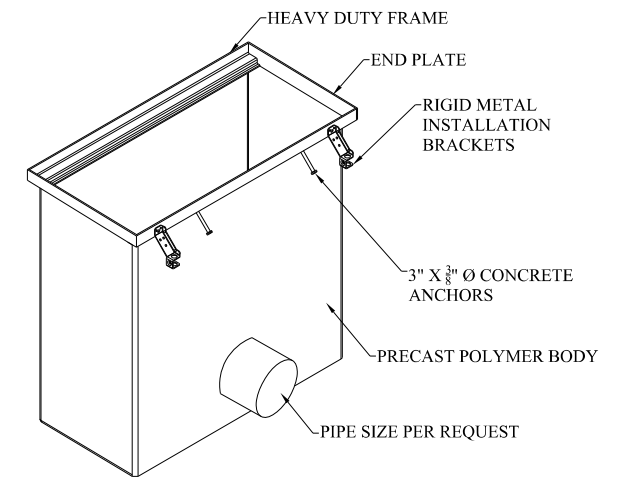

TYPICAL PRECAST CATCH BASIN ISOMETRIC

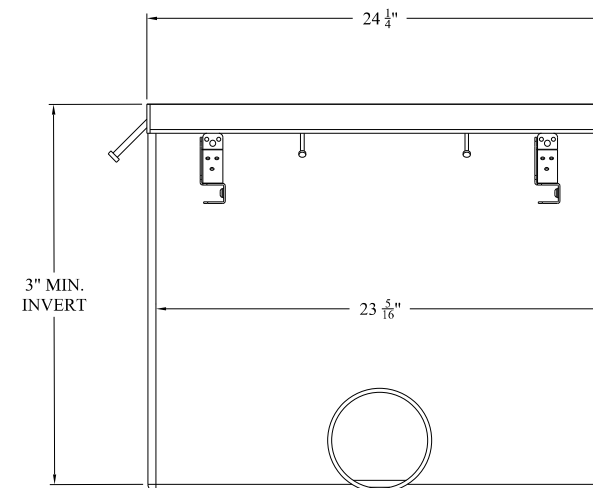

NOTES:

1. TRENCH DRAINS CAN CONNECT INTO ANY SIDE PER LAYOUT DRAWINGS.
2. OPTIONAL TRASH BUCKET IS AVAILABLE (OPTIONAL HOLE SIZES OF $\frac{1}{2}$ " , $\frac{1}{4}$ " , OR $\frac{1}{8}$ ")
3. SPECIFY OUTLET PIPE SIZE
4. FRAME TO MATCH TRENCH UNLESS SPECIFIED OTHERWISE

TYPICAL DTCBPF4 PRECAST CATCH BASIN SECTION

REVISIONS			
DATE	DESCRIPTION	DATE	DESCRIPTION

JOHNSON ENGINEERING
JOHN T. GLENN • P.E. LICENSE NO. 84227
 JOHNSON ENGINEERING, INC.
 2122 JOHNSON STREET • FORT MYERS, FL 33901
 CERTIFICATE OF AUTHORIZATION NO. 642

<i>CAPTIVA ISLAND PROPERTY OWNERS ASSOCIATION</i>		
ROAD NO.	COUNTY	JEI PROJECT ID
	LEE	20192117-000

<i>TYPICAL SECTIONS</i>
4

SHEET NO.
4

THE OFFICIAL RECORD OF THIS SHEET IS THE ELECTRONIC FILE DIGITALLY SIGNED AND SEALED UNDER RULE 61G15-23.004, F.A.C.

GENERAL NOTES

1. ELEVATIONS SHOWN ON THE PLANS ARE NATIONAL GEODETIC VERTICAL DATUM OF 1929 (NGVD29).
2. HORIZONTAL DATUM = NAV 83 FLORIDA STATE PLANE, WEST ZONE, US FOOT.
3. EXISTING FACILITIES SHALL BE RESTORED TO THAT WHICH EXISTED PRIOR TO COMMENCING CONSTRUCTION AT NO ADDITIONAL COST TO OWNER.
4. EXISTING DRAINAGE STRUCTURES WITHIN CONSTRUCTION LIMITS SHALL REMAIN, UNLESS OTHERWISE NOTED.
5. THE LOCATION(S) OF THE UTILITIES SHOWN IN THE PLANS (INCLUDING THOSE DESIGNATED Vv, Vh, AND Vvh) ARE BASED ON LIMITED INVESTIGATION TECHNIQUES AND SHOULD BE CONSIDERED APPROXIMATE ONLY. THE VERIFIED LOCATIONS/ELEVATIONS APPLY ONLY AT THE POINTS SHOWN. INTERPOLATIONS BETWEEN THESE POINTS HAVE NOT BEEN VERIFIED.
6. CONTRACTOR SHALL NOTIFY ALL UTILITY COMPANIES IN THE AREA PRIOR TO CONSTRUCTION AND CONTACT THE SUNSHINE STATE ONE CALL AT (800) 432-4770.
7. EXISTING UTILITIES ARE TO REMAIN IN PLACE UNLESS OTHERWISE NOTED.
8. UTILITY/AGENCY OWNERS

COMPANY	CONTACT	TELEPHONE NUMBERS
---------	---------	-------------------

9. ANY PUBLIC LAND CORNER WITHIN THE LIMITS OF CONSTRUCTION IS TO BE PROTECTED. IF A CORNER MONUMENT IS IN DANGER OF BEING DESTROYED AND HAS NOT BEEN PROPERLY REFERENCED, THE CONTRACTOR SHALL NOTIFY THE LEE COUNTY WITHOUT DELAY BY TELEPHONE AT (XXX) XXX-XXXX
10. CONTRACTOR SHALL PROMPTLY REPORT ALL FIELD CHANGES TO ENGINEER.
11. ALL EROSION CONTROL DEVICES ARE TO BE INSTALLED IN ACCORDANCE WITH THE STATE OF FLORIDA EROSION AND SEDIMENT CONTROL MANUAL.
12. CONTRACTOR TO MAINTAIN EXISTING TRAFFIC / ACCESS, EXISTING DRAINAGE, AND EXISTING UTILITIES DURING CONSTRUCTION, UNLESS OTHERWISE APPROVED BY LEE COUNTY.
13. CONSTRUCTION STAKING IS THE CONTRACTOR'S RESPONSIBILITY. CONTRACTOR SHALL BE RESPONSIBLE FOR COORDINATING THESE SERVICES DURING CONSTRUCTION.
14. CONTRACTOR SHALL BE RESPONSIBLE FOR ANY AND ALL CONSTRUCTION-RELATED PERMITTING. PAYMENT FOR ACQUISITION OF CONSTRUCTION-RELATED PERMITS SHALL BE INCIDENTAL TO THE COST OF CONSTRUCTION-RELATED ACTIVITIES. NO ADDITIONAL PAYMENT SHALL BE MADE.
15. CONTRACTOR SHALL NOT BRING ANY HAZARDOUS MATERIALS ONTO THE PROJECT. SHOULD THE CONTRACTOR REQUIRE SUCH FOR PERFORMING THE CONTRACTED WORK, THE CONTRACTOR SHALL REQUEST, IN WRITING, WRITTEN PERMISSION FROM THE CITY PROJECT MANAGER. THE CONTRACTOR SHALL PROVIDE LEE COUNTY PROJECT MANAGER WITH A COPY OF THE MATERIAL SAFETY DATA SHEET (MSDS) FOR EACH HAZARDOUS MATERIAL PROPOSED FOR USE. BECAUSE STATE LAW DOES NOT TREAT PETROLEUM PRODUCTS THAT ARE PROPERLY CONTAINERIZED AND INTENDED FOR EQUIPMENT USE AS A HAZARDOUS MATERIAL, SUCH PRODUCTS DO NOT NEED AN MSDS SUBMITTAL.

 ANY KNOWN OR SUSPECTED HAVARDOUS MATERIAL FOUND ON THE PROJECT BY THE CONTRACTOR SHALL BE IMMEDIATELY REPORTED TO THE CITY PROJECT MANAGER, WHO SHALL DIRECT THE CONTRACTOR TO PROTECT THAT AERA OF KNOWN OR SUSPECTED CONTAMINATION FROM FUTHER ACCESS. LEE COUNTY PROJECT MANAGER WILL ARRANGE FOR INVESTIGATION, IDENTIFICATION, AND REMEDIATION OF THE HAZARDOUS MATERIAL. THE CONTRACTOR SHALL NOT RETURN TO THE AREA OF CONTAMINATION UNTIL APPROVAL IS PROVIDED BY THE CITY PROJECT MANAGER.
16. PRIOR TO INCORPORATION INTO THE PROJECT, A CERTIFICATION FROM THE FLORIDA DEPARTMENT OF AGRICULTURE AND CONSUMER SERVICES DIVISION OF PLANT INDUSTRY, STATING THAT THE SOD, HAY, STRAW, AND MULCH MATERIALS, ARE FREE OF NOXIOUS WEEDS, INCLUDING TROPICAL SODA APPLE, SHALL BE FURNISHED TO LEE COUNTY PROJECT MANAGER BY THE CONTRACTOR. ALL SOD MATERIALS SHALL BE SUBJECT TO INSPECTION BY LEE COUNTY OR APPOINTED REPRESENTATIVE PRIOR TO PLACEMENT. ANY SOD WITH NOXIOUS WEEDS AND GRASSES, INCLUDING TROPICAL SODA APPLE, SHALL BE REJECTED FOR USE ON THE PROJECT.
17. AT THE COMPLETION OF THIS PROJECT, ALL DISTURBED SURFACES SHALL BE COVERED BY PERFORMANCE TURF.
18. CONTRACTOR SHALL BE RESPONSIBLE FOR MAINTAINING ALL EXISTING CONVEYANCES AND DRAINAGE CONNECTIONS WITHIN THE PROJECT LIMITS AT ALL TIMES.
19. CONTRACTOR SHALL REPLACE ANY EXISTING SIDE STREET MARKINGS OBLITERATED DURING CONSTRUCTION.
20. SOD QUANTITY INCLUDES ONLY THOSE AREAS INTENDED TO BE DISTURBED BY PROPOSED IMPROVEMENTS. OTHER DISTURBED AREAS NOT INTENDED TO BE DISTURBED, INCLUDING BUT NOT LIMITED TO STAGING AREAS, STOCKPILE AREAS, ETC., SHALL BE SODDED AT NO ADDITIONAL COST.

21. MAINTENANCE OF TRAFFIC SHALL BE IN ACCORDANCE WITH THE FLORIDA DEPARTMENT OF TRANSPORTATION (FDOT) INDEX 600 SERIES.
22. MAINTENANCE OF TRAFFIC PLAN MUST INCLUDE FDOT DESIGN STANDARDS INDEX 660 PEDESTRIAN CONTROL FOR CLOSURE OF SIDEWALKS.
23. LEE COUNTY DOES NOT CERTIFY THE LOCATION OR EXISTENCE OF ANY UNDERGROUND UTILITIES, NOR AS TO THE SOIL OR GROUND CONDITIONS, AND ASSUMES NO LIABILITY FOR SUCH. THE LOCATION OF UNDERGROUND UTILITIES SHALL BE THE RESPONSIBILITY OF THE CONTRACTOR. BEFORE WORKING IN AN AREA, CONTRACTOR SHALL GUARANTEE THAT ALL UNDERGROUND UTILITIES HAVE BEEN LOCATED
24. IT IS RECOMMENDED THAT THE CONTRACTOR CONDUCT SITE INVESTIGATIONS TO SATISFY HIM/HERSELF WITH THE EXISTING TOPOGRAPHY AND GENERAL CONDITION OF THE AREA OF WORK. ANY FAILURE BY THE CONTRACTOR TO ACQUAINT HIM/HERSELF WITH THE AVAILABLE INFORMATION AND FIELD CONDITIONS WILL NOT RELIEVE HIM/HER FROM RESPONSIBILITY FOR ESTIMATING PROPERLY THE DIFFICULTY OR COST OF SUCCESSFULLY PERFORMING THE WORK.
25. THE ENGINEER SHALL BE CONSULTED TO MAKE ANY REQUIRED INTERPRETATIONS OF THE PLANS, HOWEVER, THIS IN NO WAY RELIEVES THE CONTRACTOR OF HIS/HER RESPONSIBILITY FOR CONSTRUCTING THE PROJECT IN ACCORDANCE WITH THE INTENT OF THE PLANS. THE CONTRACTOR SHALL REFER TO THE CONTRACT DOCUMENTS FOR ADDITIONAL CONTROL AND SCOPE OF WORK.
26. EACH ITEM LISTED IN SUMMARY OF ESTIMATED QUANTITIES IS TO INCLUDE ALL WORK AND MATERIALS NECESSARY TO COMPLETE THE ITEM. PAYMENT FOR CONTRACT ITEMS WILL BE BASED ON ACTUAL FIELD (IN-PLACE) MEASUREMENTS OF THE COMPLETED ITEMS, READY FOR SERVICE AND ACCEPTED BY LEE COUNTY. ANY DISCREPANCIES BETWEEN THE PLANS AND FIELD CONDITIONS SHALL BE BROUGHT TO THE ATTENTION OF THE ENGINEER. THE QUANTITIES AS PROVIDED ARE APPROXIMATE ONLY AND NO CLAIM SHALL BE MADE AGAINST LEE COUNTY FOR ANY EXCESS OR DEFICIENCY. THE CONSTRUCTION LENGTHS INDICATED IN THESE PLANS ARE APPROXIMATE. ACTUAL LIMITS MAY BE SET IN THE FIELD AS DIRECTED BY THE ENGINEER. REQUIRED WORK NOT ITEMIZED UNDER SUMMARY OF ESTIMATED QUANTITIES OR SPECIAL PROVISIONS SHALL BE INCIDENTAL TO THE CONTRACT.
27. THE CONTRACTOR SHALL FURNISH, ERECT AND MAINTAIN ALL NECESSARY TRAFFIC CONTROL AND SAFETY DEVICES, IN CLUDING TEMPORARY PAVEMENT MARKING, IN ACCORDANCE WITH THE U.S. DEPARTMENT OF TRANSPORTATION "MANUAL ON UNIFORM TRAFFIC CONTROL DEVICES" DECEMBER 2009, AND THE CURRENT FLORIDA DEPARTMENT OF TRANSPORTATION "ROADWAY AND TRAFFIC DESIGN STANDARDS" 2016, AS AMENDED BY THE SPECIFICATIONS FOR THIS PROJECT.
28. ANY MAILBOX WITHIN THE LIMITS OF CONSTRUCTION IS TO BE TAKEN DOWN AND RESET BY THE CONTRACTOR IN ACCORDANCE WITH POSTAL REQUIREMENTS; COST TO BE INCLUDED UNDER 110-7-1. REMOVAL AND RELOCATION OF MAILBOXES IS INCIDENTAL TO THIS PAY ITEM. REPLACEMENT OF MAILBOXES DAMAGED DURING REMOVAL AND RELOCATION IS THE RESPONSIBILITY OF THE CONTRACTOR.
29. ANY EXISTING PAVEMENT THAT IS TO BE REMOVED MUST BE SAW-CUT PRIOR TO REMOVAL. WHERE CONNECTIONS TO EXISTING WALKS AND DRIVES ARE NOT INDICATED ON THE PLANS, PROPER CONNECTIONS SHALL BE MADE AT THE DIRECTION OF THE ENGINEER.
30. ALL STATIONS AND OFFSETS REFER TO THE CENTER LINE OF CONSTRUCTION UNLESS OTHERWISE NOTED. DIMENSIONS REFER TO THE EDGE OF PAVEMENT (E/P) UNLESS OTHERWISE NOTED.
31. ALL PROPOSED STRUCTURES AND STORMWATER FACILITIES LOCATED WITHIN THE RIGHT-OF-WAY SHALL BE CLEANED PRIOR TO ACCEPTANCE OF CONTRACT. COST SHALL BE INCLUDED IN MOBILIZATION PAY ITEM 101-1.

REVISIONS				 JOHN T. GLENN • P.E. LICENSE NO. 84227 JOHNSON ENGINEERING, INC. 2122 JOHNSON STREET • FORT MYERS, FL 33901 CERTIFICATE OF AUTHORIZATION NO. 642	CAPTIVA ISLAND PROPERTY OWNERS ASSOCIATION			SHEET NO. 6
DATE	DESCRIPTION	DATE	DESCRIPTION		ROAD NO.	COUNTY	JEI PROJECT ID	
						LEE	20192117-000	

PROJECT NOTES

THE OFFICIAL RECORD OF THIS SHEET IS THE ELECTRONIC FILE DIGITALLY SIGNED AND SEALED UNDER RULE 61G15-23.004, F.A.C.

CONTROL POINT TABLE

POINT NO.	COORDINATES		ELEVATION	STATION	OFFSET	DESCRIPTION
	NORTH	EAST				
CP9	795467.399	594131.961	4.48	12+78.69	1.97 LT	FPK BROKEN OFF CP9
CP10	795659.389	594142.339	4.21	14+70.88	1.12 LT	FPKD LB 642 TRAV PT CP 10
CP11	795858.458	594153.009	4.39	16+70.23	0.43 LT	FPKD LB 642 TRAV PT CP 11
CP12	796049.060	594163.402	4.04	18+61.12	0.40 RT	FPKD LB 642 TRAV PT CP 12
CP13	796138.819	594168.254	4.29	19+51.01	0.76 RT	FPKD LB 642 TRAV PT CP 13
CP14	796288.280	594176.333	4.93	21+00.68	1.34 RT	FPKD LB 642 TRAV PT CP 14
CP15	796422.984	594183.614	4.77	22+35.31	1.89 RT	FPKD LB 642 TRAV PT CP 15
CP16	796493.819	593976.429	4.04	24+52.55	1.54 RT	FPKD LB 642 TRAV PT CP 16
CP17	796570.037	593753.498	4.23	26+88.14	2.37 RT	FPKD LB 642 TRAV PT CP 17
CP18	796641.846	593543.464	4.64	29+10.11	3.15 RT	FPKD LB 642 TRAV PT CP 18
CP19	796677.471	593439.266	4.54	30+20.23	3.53 RT	FPKD LB 642 TRAV PT CP 19
CP20	769757.937	593203.911	5.51	32+68.96	4.41 RT	FPKD LB 642 TRAV PT CP 20

CL CONST. CAPTIVA DRIVE

ALIGNMENT	POINT NO.	COORDINATES		CONTROL	STATION
		NORTH	EAST		
CAPTIVA DRIVE	CL1	795388.793	594129.890	POT	12+00.00
CAPTIVA DRIVE	CL2	796422.801	594181.737	PI	22+35.31
CAPTIVA DRIVE	CL3	796769.984	593154.506	PI	33+19.62
CAPTIVA DRIVE	CL4	796781.795	593126.052	POT	33+55.23

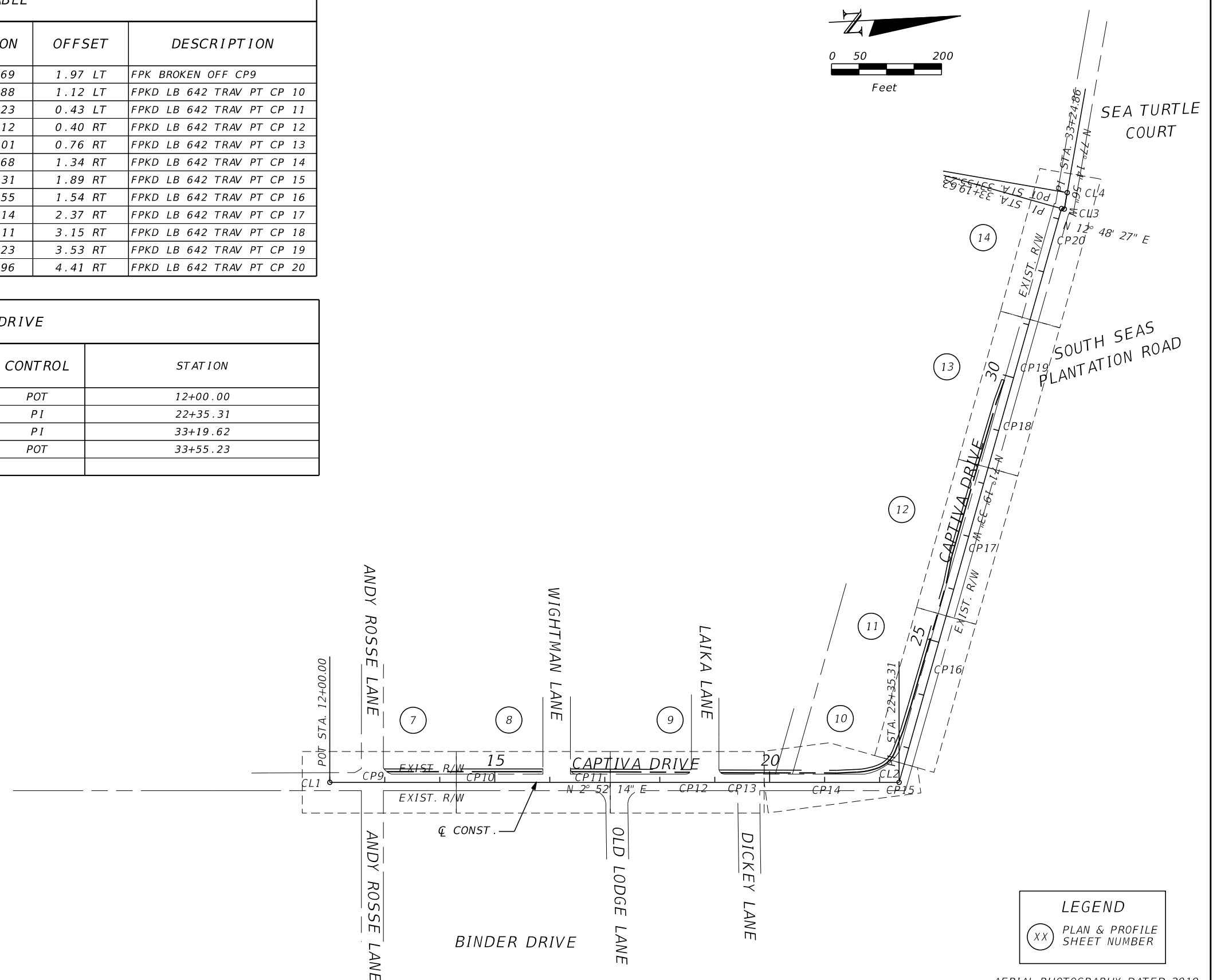
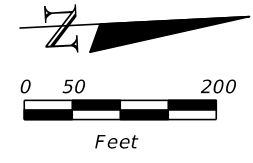

LEGEND

(XX) PLAN & PROFILE SHEET NUMBER

AERIAL PHOTOGRAPHY DATED 2019

REVISIONS			
DATE	DESCRIPTION	DATE	DESCRIPTION

JOHNSON ENGINEERING
 JOHN T. GLENN • P.E. LICENSE NO. 84227
 JOHNSON ENGINEERING, INC.
 2122 JOHNSON STREET • FORT MYERS, FL 33901
 CERTIFICATE OF AUTHORIZATION NO. 642

CAPTIVA ISLAND PROPERTY OWNERS ASSOCIATION		
ROAD NO.	COUNTY	JEI PROJECT ID
	LEE	20192117-000

PROJECT LAYOUT

SHEET NO.
7

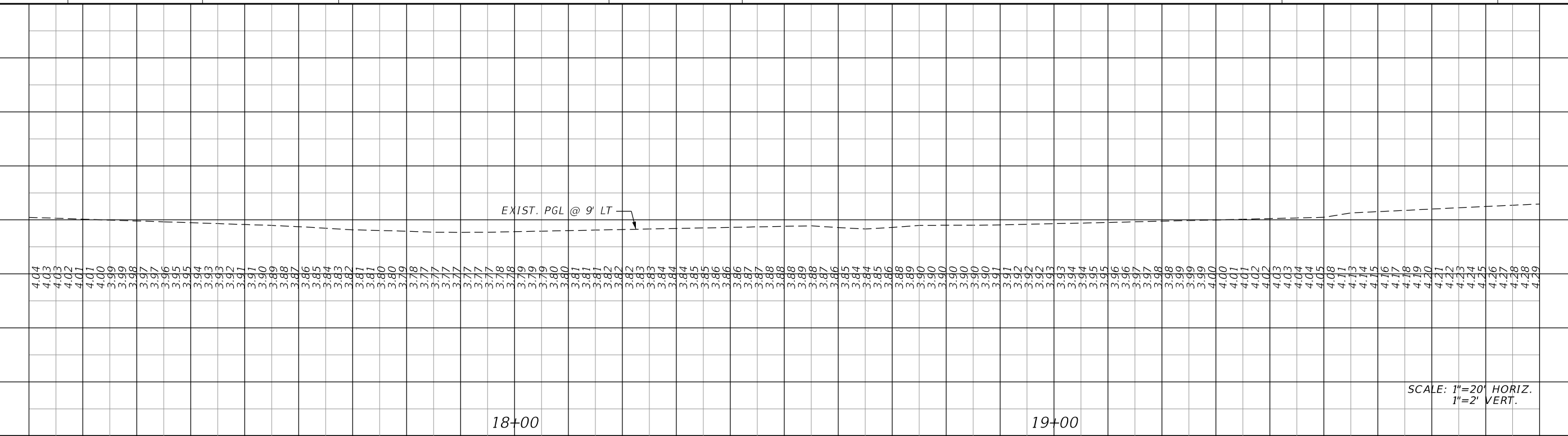
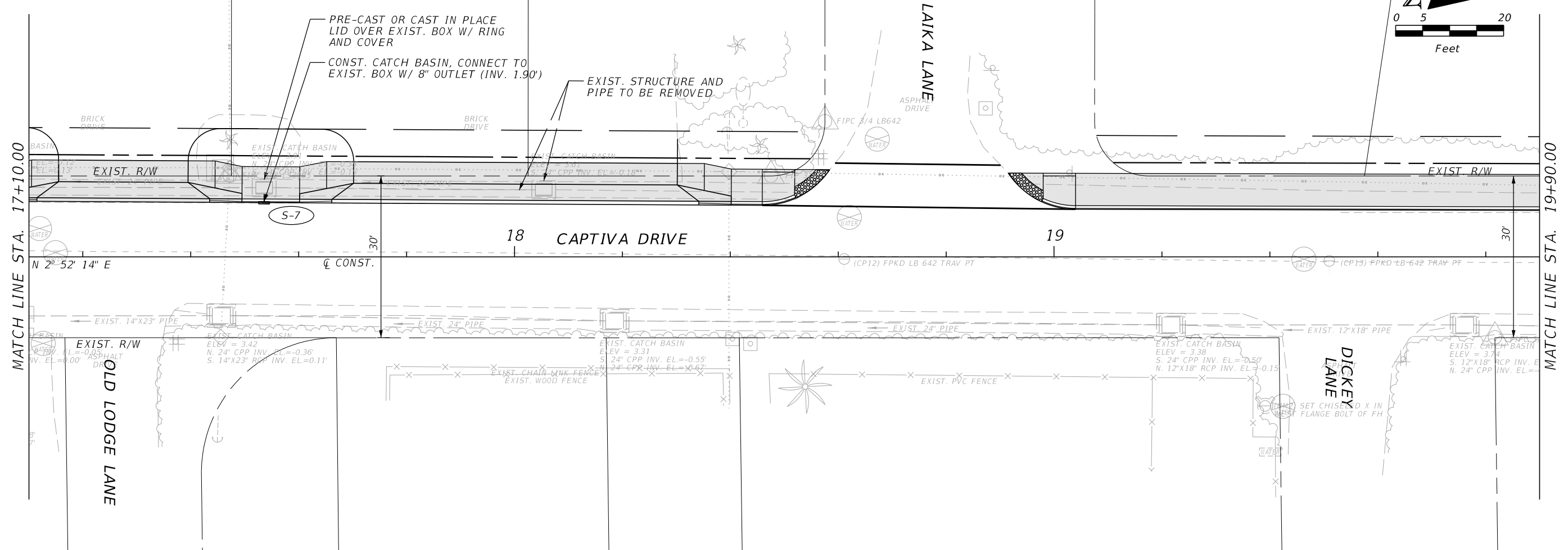
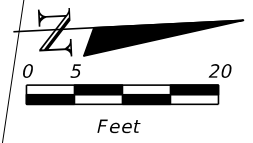

SCALE: 1"=20' HORIZ.
1"=2' VERT.

REVISIONS			
DATE	DESCRIPTION	DATE	DESCRIPTION

JOHNSON ENGINEERING
 JOHN T. GLENN • P.E. LICENSE NO. 84227
 JOHNSON ENGINEERING, INC.
 2122 JOHNSON STREET • FORT MYERS, FL 33901
 CERTIFICATE OF AUTHORIZATION NO. 642

CAPTIVA ISLAND PROPERTY OWNERS ASSOCIATION		
ROAD NO.	COUNTY	JEI PROJECT ID
	LEE	20192117-000

PLAN AND PROFILE
STA. 17+00 TO STA. 19+90

SHEET NO.
9

THE OFFICIAL RECORD OF THIS SHEET IS THE ELECTRONIC FILE DIGITALLY SIGNED AND SEALED UNDER RULE 61G15-23.004, F.A.C.

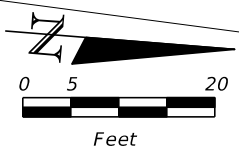

LEGEND

	PROPOSED R/W
	TEMPORARY CONSTRUCTION EASEMENT

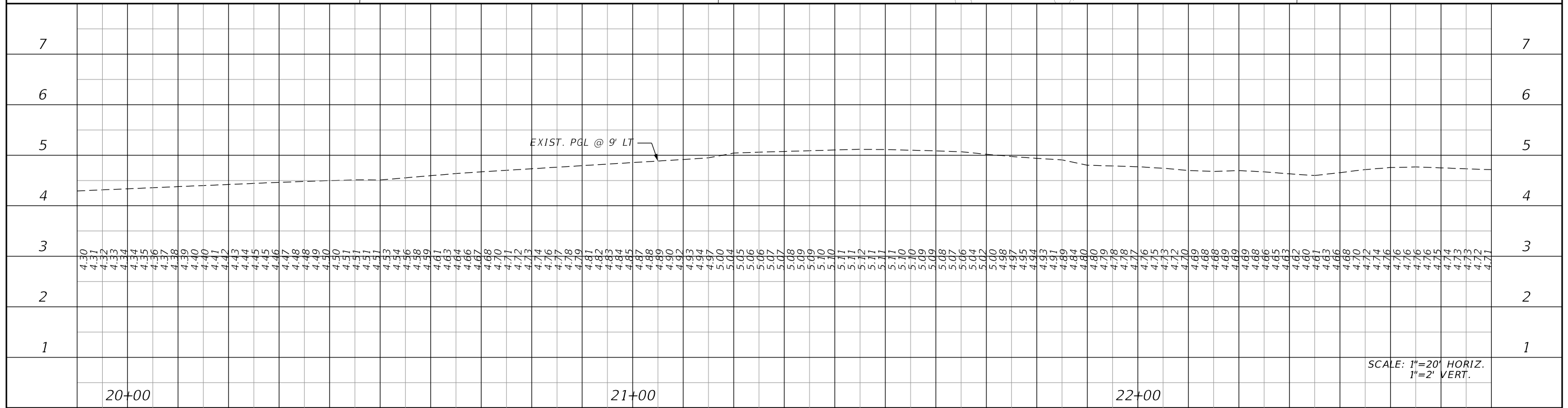
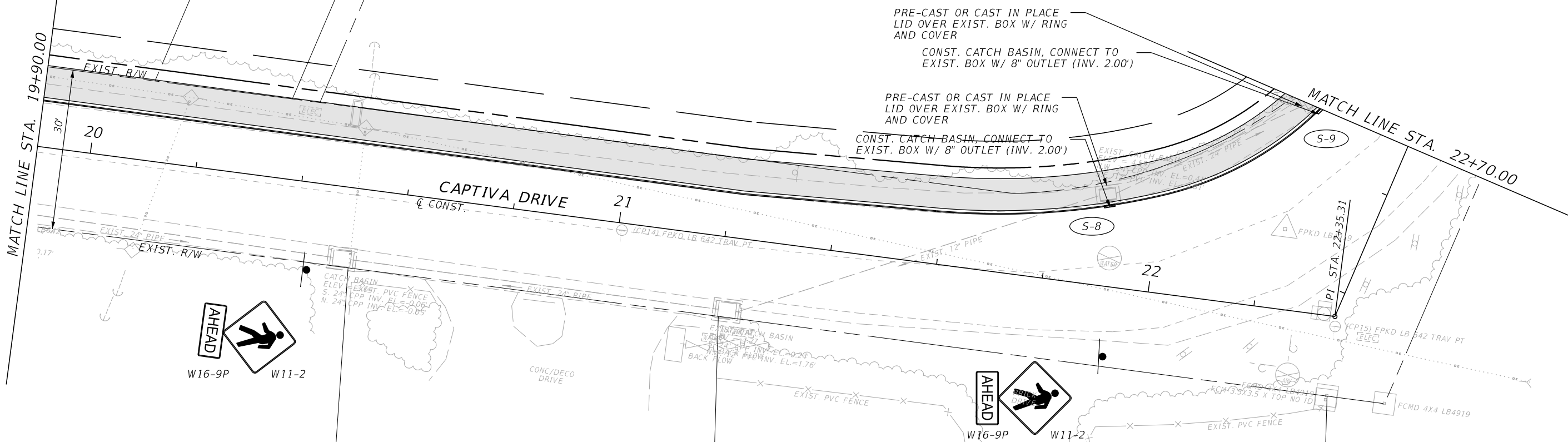

SCALE: 1"=20' HORIZ.
1"=2' VERT.

REVISIONS			
DATE	DESCRIPTION	DATE	DESCRIPTION

JOHNSON ENGINEERING
 JOHN T. GLENN • P.E. LICENSE NO. 84227
 JOHNSON ENGINEERING, INC.
 2122 JOHNSON STREET • FORT MYERS, FL 33901
 CERTIFICATE OF AUTHORIZATION NO. 642

CAPTIVA ISLAND PROPERTY OWNERS ASSOCIATION		
ROAD NO.	COUNTY	JEI PROJECT ID
	LEE	20192117-000

PLAN AND PROFILE
STA. 19+90 TO STA. 22+70

SHEET NO.
10

THE OFFICIAL RECORD OF THIS SHEET IS THE ELECTRONIC FILE DIGITALLY SIGNED AND SEALED UNDER RULE 61G15-23.004, F.A.C.

Q CONST.

Regular Exc. Embankment

Q CONST.

Regular Exc. Embankment

A V A V

A V A V

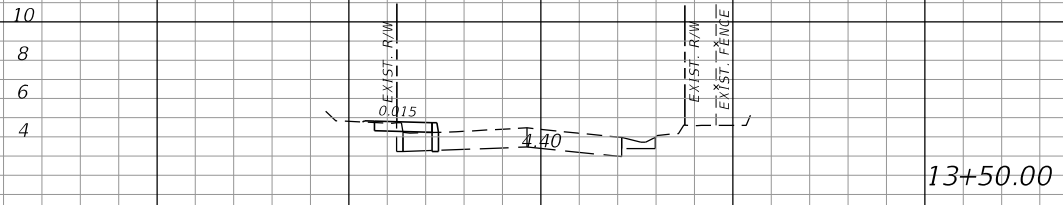

13+50.00

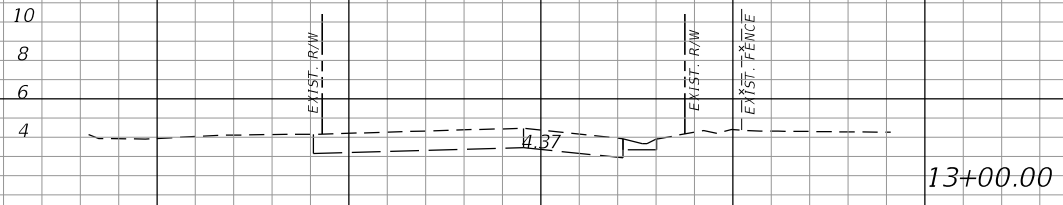

13+00.00

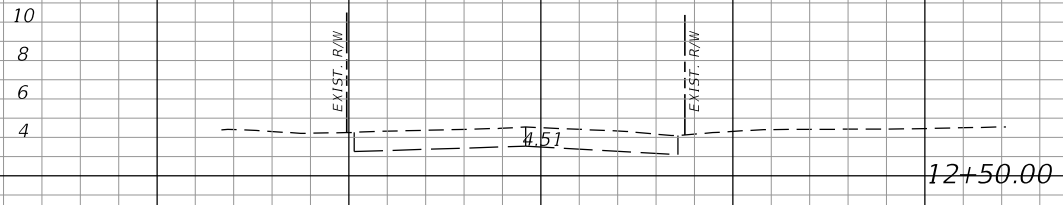

12+50.00

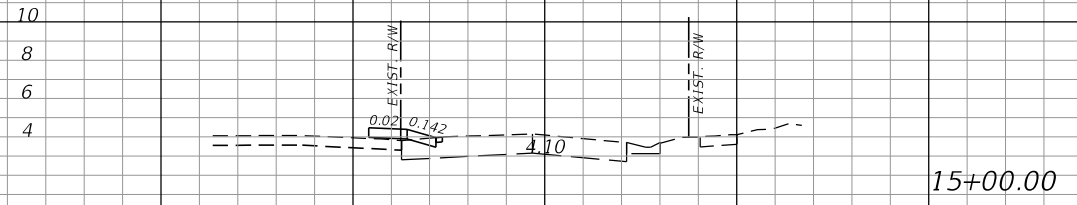

15+00.00

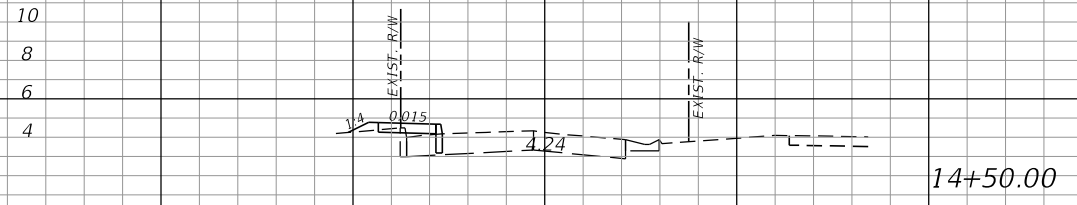

14+50.00

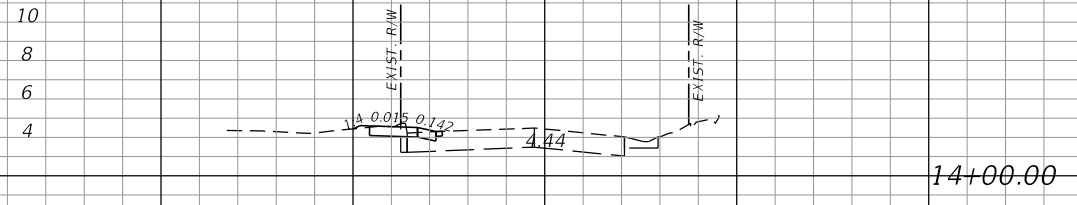

14+00.00

SCALE: 1"=20' HORIZ.
1"=10' VERT.

REVISIONS			
DATE	DESCRIPTION	DATE	DESCRIPTION

JOHNSON ENGINEERING
 JOHN T. GLENN • P.E. LICENSE NO. 84227
 JOHNSON ENGINEERING, INC.
 2122 JOHNSON STREET • FORT MYERS, FL 33901
 CERTIFICATE OF AUTHORIZATION NO. 642

CAPTIVA ISLAND PROPERTY OWNERS ASSOCIATION

ROAD NO.	COUNTY	JEI PROJECT ID
	LEE	20192117-000

CROSS SECTIONS

SHEET NO.
15

THE OFFICIAL RECORD OF THIS SHEET IS THE ELECTRONIC FILE DIGITALLY SIGNED AND SEALED UNDER RULE 61G15-23.004, F.A.C.

Q CONST.

Regular Exc. Embankment

Q CONST.

Regular Exc. Embankment

A V A V

A V A V

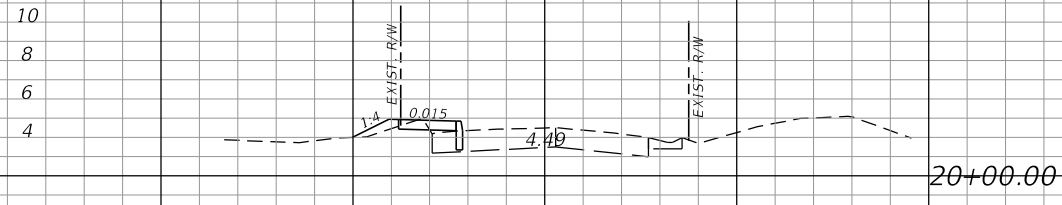
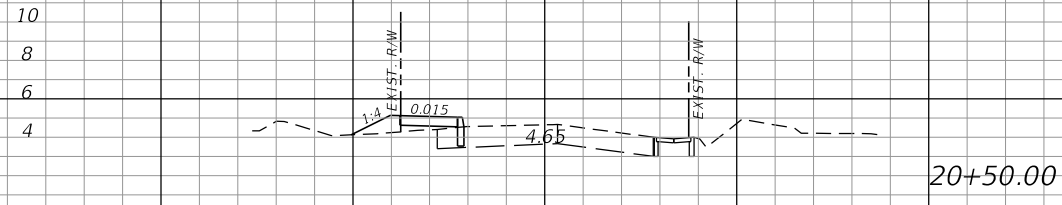
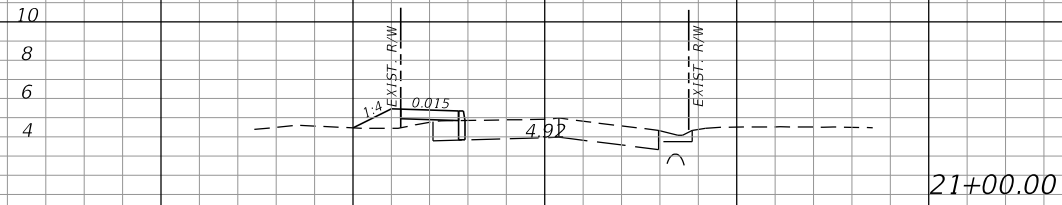
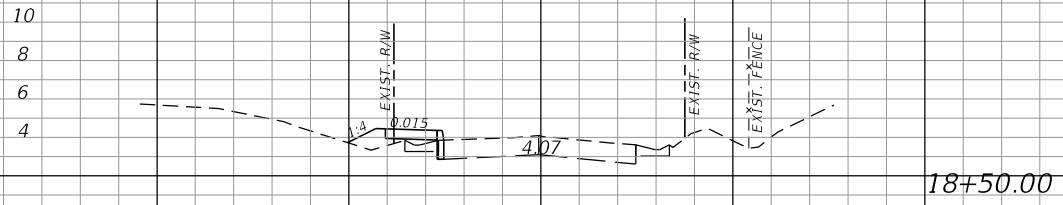
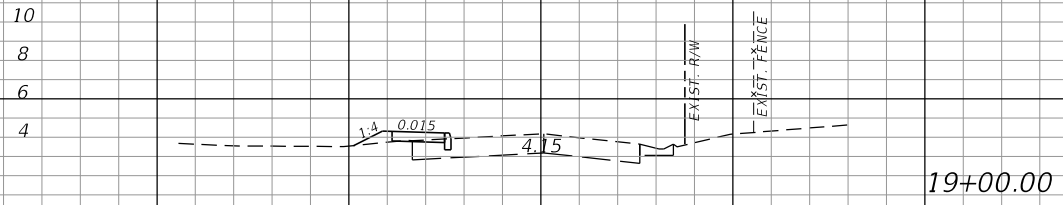
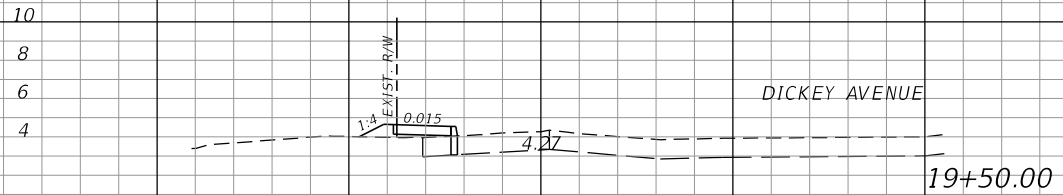

SCALE: 1"=20' HORIZ.
1"=10' VERT.

REVISIONS			
DATE	DESCRIPTION	DATE	DESCRIPTION

JOHNSON ENGINEERING
 JOHN T. GLENN • P.E. LICENSE NO. 84227
 JOHNSON ENGINEERING, INC.
 2122 JOHNSON STREET • FORT MYERS, FL 33901
 CERTIFICATE OF AUTHORIZATION NO. 642

CAPTIVA ISLAND PROPERTY OWNERS ASSOCIATION		
ROAD NO.	COUNTY	JEI PROJECT ID
	LEE	20192117-000

CROSS SECTIONS

SHEET NO.
17

THE OFFICIAL RECORD OF THIS SHEET IS THE ELECTRONIC FILE DIGITALLY SIGNED AND SEALED UNDER RULE 61G15-23.004, F.A.C.

Q CONST.

Regular Exc. Embankment

Q CONST.

Regular Exc. Embankment

A

V

A

V

A

V

A

V

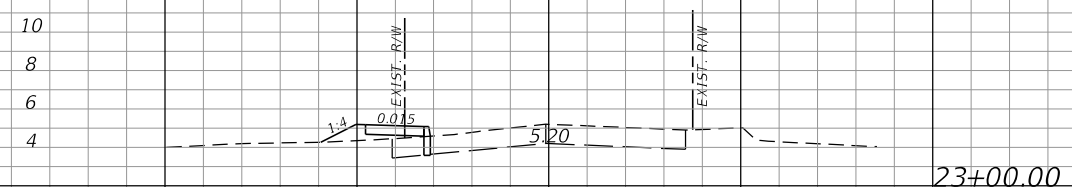
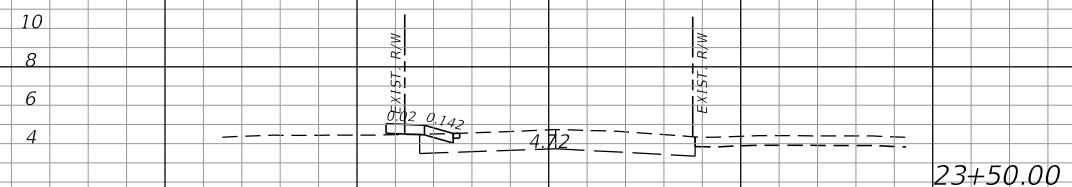
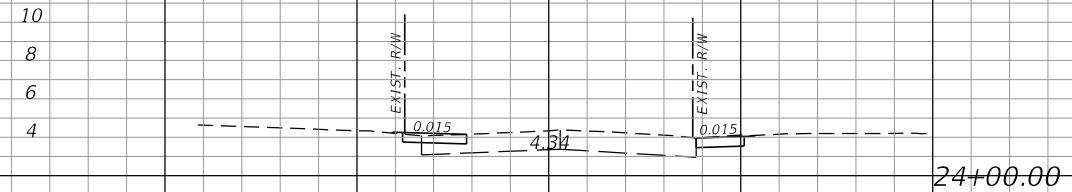
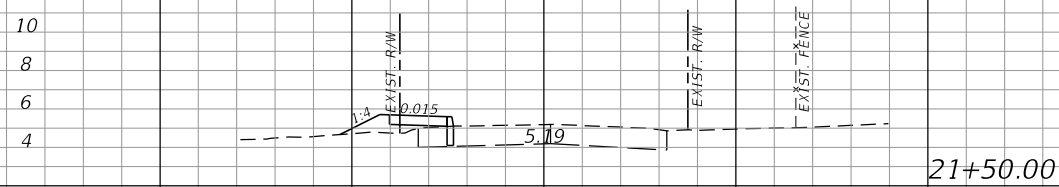
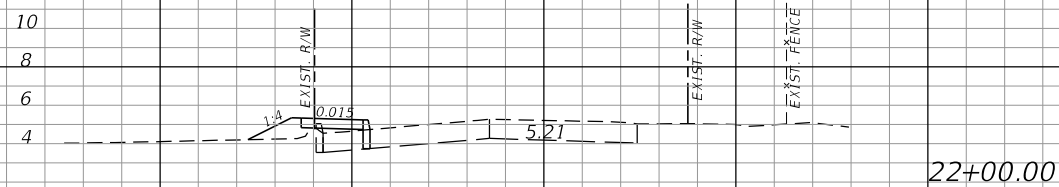
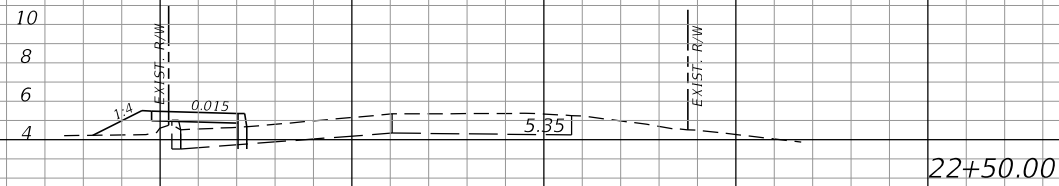

SCALE: 1"=20' HORIZ.
1"=10' VERT.

60 40 20 0 20 40 60

60 40 20 0 20 40 60

REVISIONS

DATE	DESCRIPTION	DATE	DESCRIPTION

JOHNSON
ENGINEERING

JOHN T. GLENN • P.E. LICENSE NO. 84227
JOHNSON ENGINEERING, INC.
2122 JOHNSON STREET • FORT MYERS, FL 33901
CERTIFICATE OF AUTHORIZATION NO. 642

CAPTIVA ISLAND
PROPERTY OWNERS ASSOCIATION

ROAD NO.	COUNTY	JEI PROJECT ID
	LEE	20192117-000

CROSS SECTIONS

SHEET NO.

18

THE OFFICIAL RECORD OF THIS SHEET IS THE ELECTRONIC FILE DIGITALLY SIGNED AND SEALED UNDER RULE 61G15-23.004, F.A.C.

Q CONST.

Regular Exc. Embankment

Q CONST.

Regular Exc. Embankment

A

V

A

V

A

V

A

V

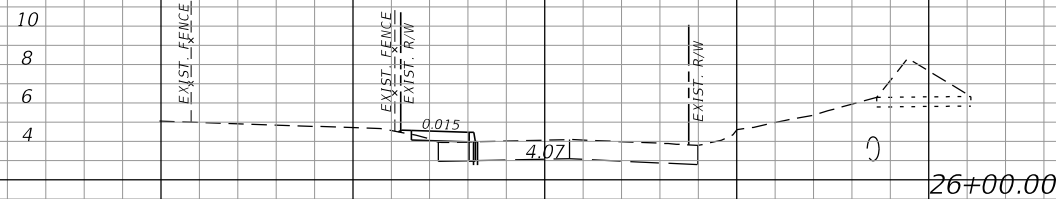
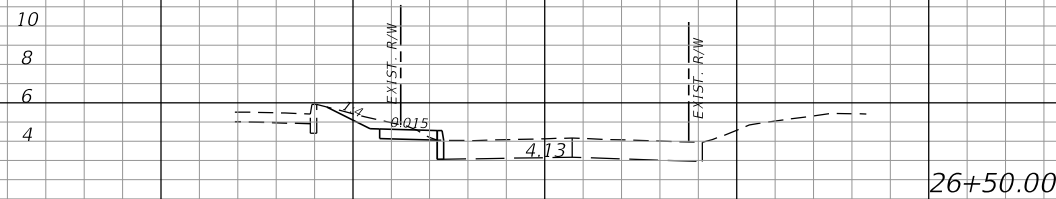
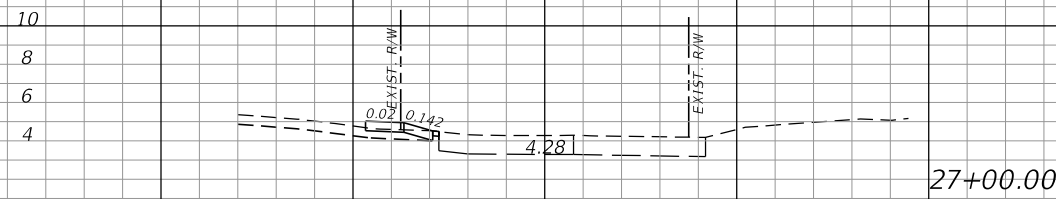
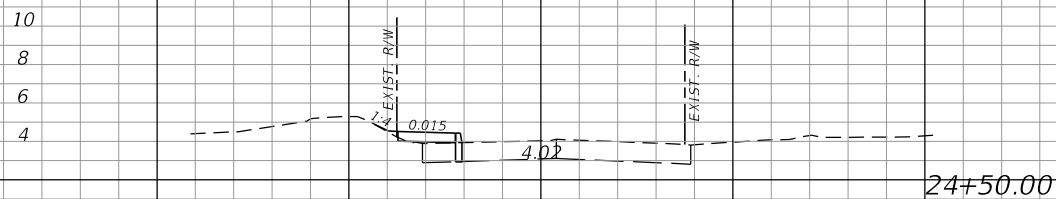
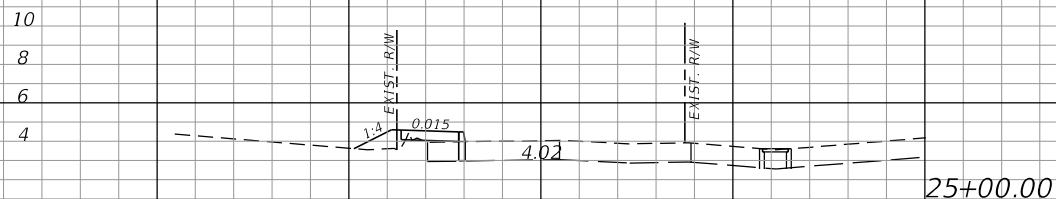
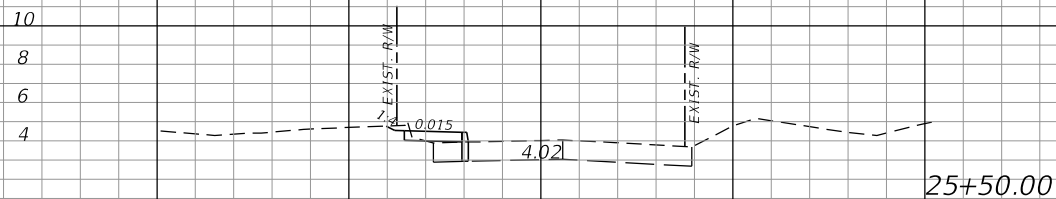

SCALE: 1"=20' HORIZ.
1"=10' VERT.

REVISIONS			
DATE	DESCRIPTION	DATE	DESCRIPTION

JOHNSON ENGINEERING
 JOHN T. GLENN • P.E. LICENSE NO. 84227
 JOHNSON ENGINEERING, INC.
 2122 JOHNSON STREET • FORT MYERS, FL 33901
 CERTIFICATE OF AUTHORIZATION NO. 642

CAPTIVA ISLAND PROPERTY OWNERS ASSOCIATION

ROAD NO.	COUNTY	JEI PROJECT ID
	LEE	20192117-000

CROSS SECTIONS

SHEET NO.
19

THE OFFICIAL RECORD OF THIS SHEET IS THE ELECTRONIC FILE DIGITALLY SIGNED AND SEALED UNDER RULE 61G15-23.004, F.A.C.

Q CONST.

Regular Exc. Embankment

Q CONST.

Regular Exc. Embankment

A

V

A

V

A

V

A

V

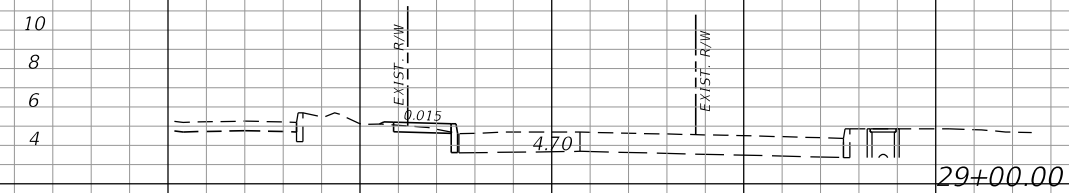
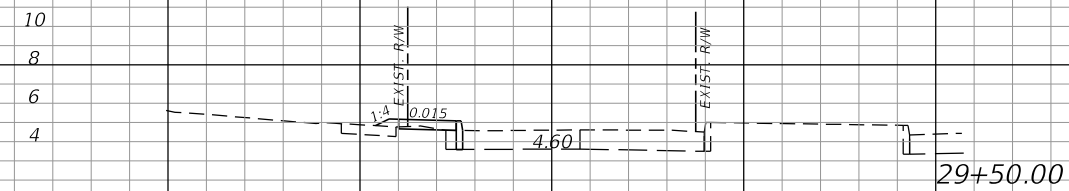
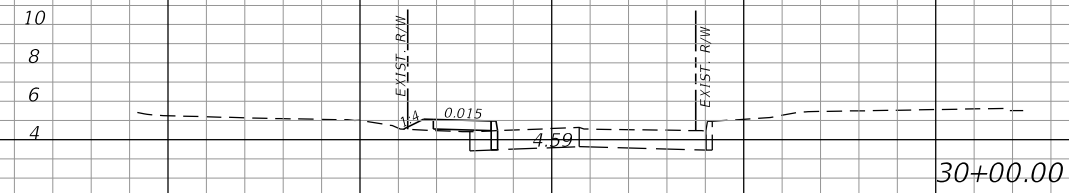
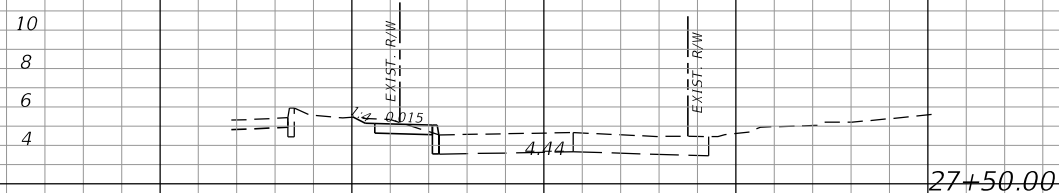
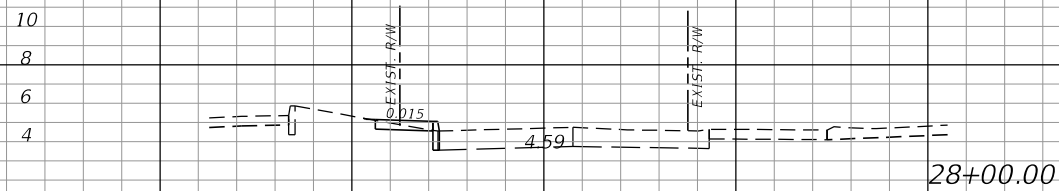
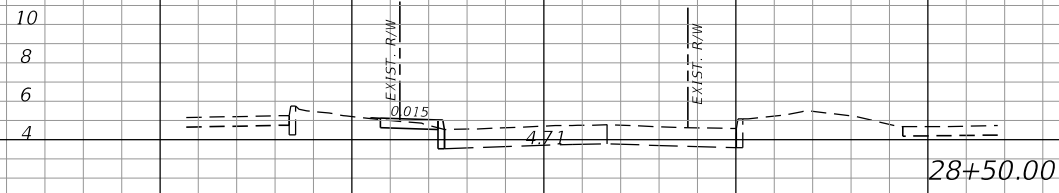

SCALE: 1"=20' HORIZ.
1"=10' VERT.

REVISIONS			
DATE	DESCRIPTION	DATE	DESCRIPTION

JOHNSON ENGINEERING
 JOHN T. GLENN • P.E. LICENSE NO. 84227
 JOHNSON ENGINEERING, INC.
 2122 JOHNSON STREET • FORT MYERS, FL 33901
 CERTIFICATE OF AUTHORIZATION NO. 642

CAPTIVA ISLAND PROPERTY OWNERS ASSOCIATION		
ROAD NO.	COUNTY	JEI PROJECT ID
	LEE	20192117-000

CROSS SECTIONS

SHEET NO. 20

THE OFFICIAL RECORD OF THIS SHEET IS THE ELECTRONIC FILE DIGITALLY SIGNED AND SEALED UNDER RULE 61G15-23.004, F.A.C.

Q CONST.

Regular Exc. Embankment

Q CONST.

Regular Exc. Embankment

A

V

A

V

A

V

A

V

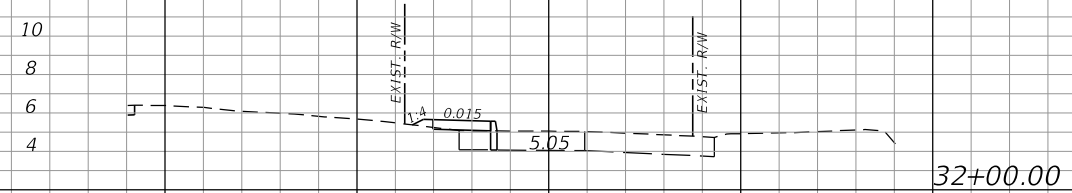
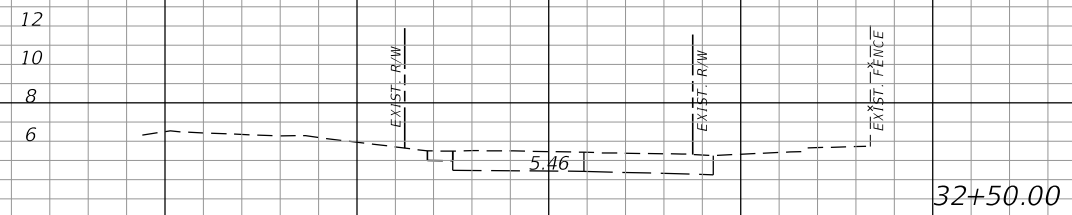
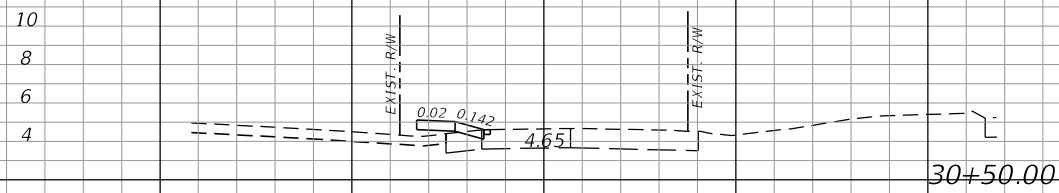
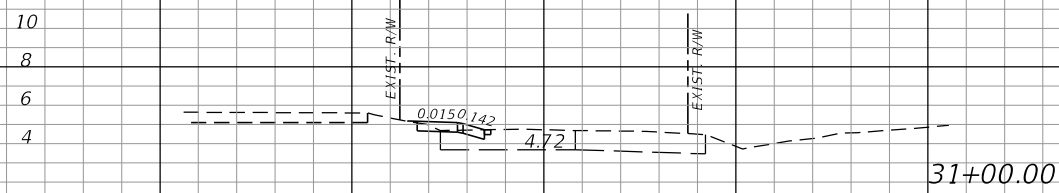
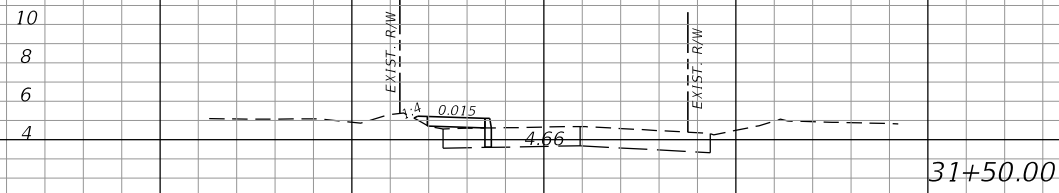

SCALE: 1"=20' HORIZ.
1"=10' VERT.

REVISIONS			
DATE	DESCRIPTION	DATE	DESCRIPTION

JOHNSON ENGINEERING
 JOHN T. GLENN • P.E. LICENSE NO. 84227
 JOHNSON ENGINEERING, INC.
 2122 JOHNSON STREET • FORT MYERS, FL 33901
 CERTIFICATE OF AUTHORIZATION NO. 642

CAPTIVA ISLAND PROPERTY OWNERS ASSOCIATION		
ROAD NO.	COUNTY	JEI PROJECT ID
	LEE	20192117-000

CROSS SECTIONS

SHEET NO.

21

THE OFFICIAL RECORD OF THIS SHEET IS THE ELECTRONIC FILE DIGITALLY SIGNED AND SEALED UNDER RULE 61G15-23.004, F.A.C.